

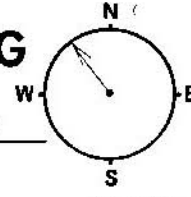

GEOPHYSICAL SERVICES INC. ALASKA DIMENSIONLESS LINE LOG



PARTY 1186 LINE No. 22-81 GROUP INTERVAL 110 DATE 26 JAN '81 LINE PROGRESSION N-NW

LEGEND:

- 1. LAKE
- 2. RIVER/CREEK
- 3. SEA ICE
- 4. ICE LEAD
- 5. PRESSURE RIDGE
- 6. ROAD
- 7. PIPELINE
- 8. DRILLING RIG
- 9. PUMP STATION
- 10. BUILDING
- 11. ISLAND
- 12. HILL
- 13. RAVINE
- 14. DRIVE AROUND THIS WAY
- 15. STACK SP/VP ON THIS SP/VP
- 16. GROUP
- 17. VP/SP
- 18. NO PERMIT AREA

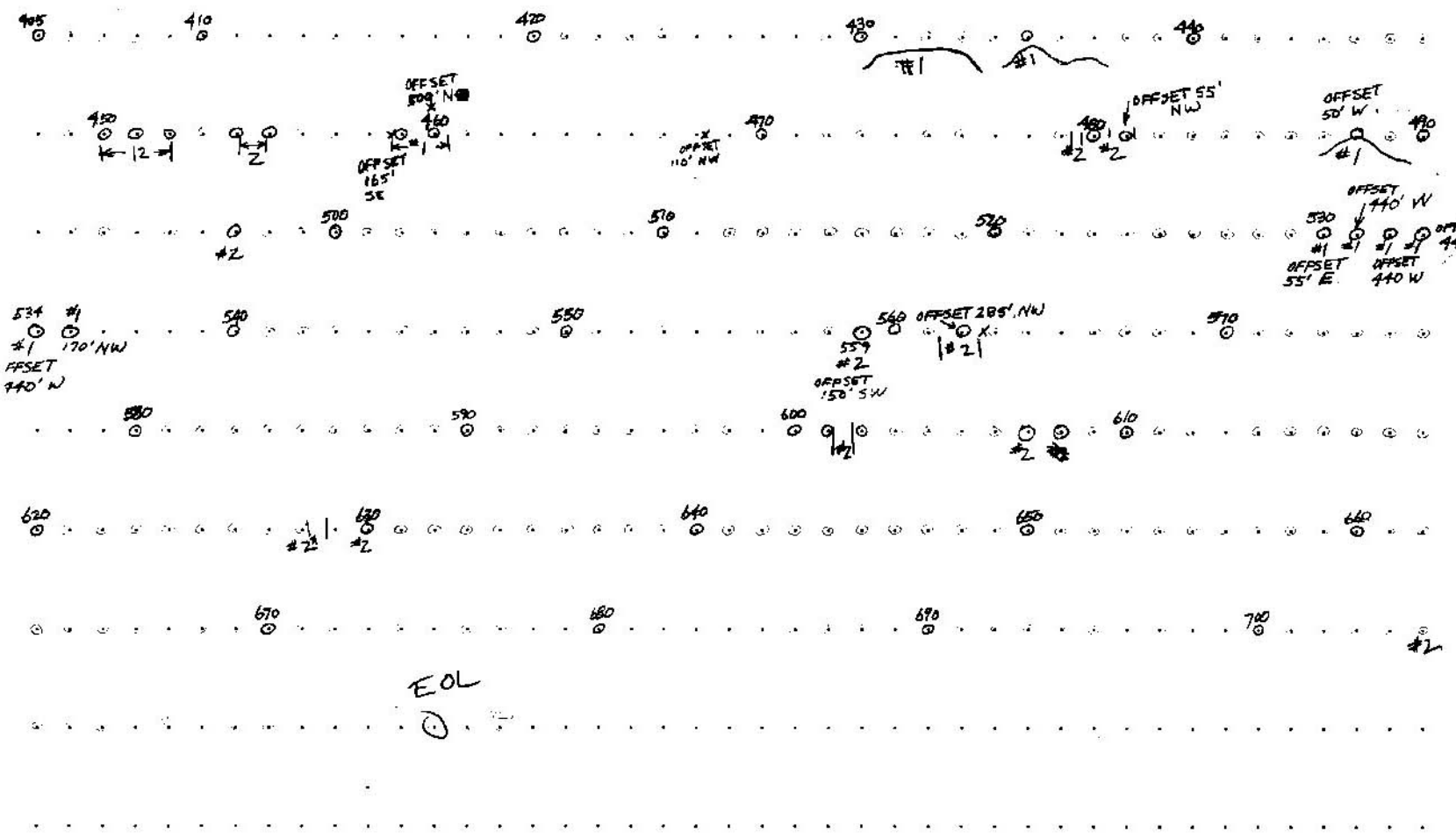

EOL

REMARKS:

ALASKA LAND SEISMIC RECORDING LOG

	CLIENT: <u>U.S.G.S</u>	PROSPECT:	AREA: <u>NPRA</u>	LINE NO: <u>22481</u>	
	PARTY NO: <u>1196</u>	INST. ENG: <u>Hammond/Czek</u>		DATE: <u>4 DAY 8 YE 81</u>	

INSTRUMENT (9-TRACK)	<input checked="" type="checkbox"/> 1 SYSTEM <input type="checkbox"/> 2 SYSTEMS	<input type="checkbox"/> 1-24 & 25-48 <input checked="" type="checkbox"/> 1-48 & 49-96	<input type="checkbox"/> 1-80 <input type="checkbox"/> 81-120	TYPE:	<input checked="" type="checkbox"/> DFS <input type="checkbox"/> OTHER	POP.MAT: <u>B</u> SEG:	<input type="checkbox"/> GAPPED <input checked="" type="checkbox"/> UNGAPPED	PACKING DENSITY:	<input type="checkbox"/> 800 BPI <input checked="" type="checkbox"/> 1600 BPI
	NO. BYTES IN HEADER REC: <u>220</u>	NO. BYTES IN RECORD ID:	NO. BYTES PER SCAN: <u>2</u>			GAIN CONSTANT: <u>48</u> db	INPUT IMPEDANCE: <u>2000</u> ohms.		
CONFIGURATION (MAG TAPE)	FIELD TRACE NOS.: <u>1-48/49-96</u>				AUXILIARY DATA: (1) <u>SPS</u> (2) <u>CHK.T.B.</u> (3) <u>Cont.</u> (4) (5) (6) (7)				
	DATA CHANNEL NOS.:				AUXILIARY CHANNEL NOS.: <u>97 98 99</u>				
PARAMETER	RECORD LENGTH: <u>6</u> sec.	SAMPLE RATE: <input type="checkbox"/> 1 ms. <input type="checkbox"/> 4 ms. <input checked="" type="checkbox"/> 2 ms.	GAIN MODE: <input checked="" type="checkbox"/> INITIAL <input type="checkbox"/> FINAL	FILTERS: FREQ. <u>8</u> LO CUT HZ SLOPE <u>18</u> HI CUT HZ SLOPE <u>128</u> NOTCH FILTER: <input checked="" type="checkbox"/> IN <input type="checkbox"/> OUT					
DISPLAY	MODE: <input checked="" type="checkbox"/> AGC <input type="checkbox"/> DEFOAT	INITIAL GAIN: <u>18</u> db	TRIP SENS.: <u>30</u> db	POLARITY CONVENTION: <input type="checkbox"/> NEGATIVE <input checked="" type="checkbox"/> POSITIVE		PRESSURE INCREASE ON GEOPHONE: <input type="checkbox"/> NEGATIVE <input checked="" type="checkbox"/> POSITIVE		NUMBERS ON MAG. TAPE: <input checked="" type="checkbox"/> DOWNBREAK <input type="checkbox"/> UPBREAK <input type="checkbox"/> ON DISPLAY	
FT 1	TYPE STACK:	GATE LENGTH:	RECORD REJECTION:	NOISE REDUCTION:		NOISE THRESHOLD:		CORR. SCALING:	
SOURCE	TYPE: <input checked="" type="checkbox"/> DYNAMITE <input type="checkbox"/> VIBROSEIS <input type="checkbox"/> OTHER	PATTERN: <u>Single Hole</u>	NO. OF POSITIONS: <u>1</u>	INLINE SPACING: <u>440'</u>	LATERAL SPACING: <u>—</u>	STAGGER: <u>—</u>	LENGTH: <u>—</u>	WIDTH: <u>—</u>	LATERAL OFFSET: <u>—</u>
		CHG/ HOLE: <u>50 II</u>	HOLE DEPTH: <u>90'</u>	SWEEP POSITION: <u>—</u>	SWEEP START: <u>—</u>	SWEEP END: <u>—</u>	SWEEP LENGTH: <u>—</u>	SWEEP TAPER: <u>—</u>	PHASE COMP.: <u>—</u>
RECEIVER	TYPE: <u>G/S 20 D</u>	PATTERN: <u>Inline</u>	NO. OF ELEMENTS: <u>18</u>	INLINE SPACING: <u>6.5'</u>	LATERAL SPACING: <u>—</u>	STAGGER: <u>—</u>	LENGTH: <u>—</u>	WIDTH: <u>—</u>	LATERAL OFFSET: <u>—</u>
	CONNECTION: <u>Series/Parallel</u>	RESISTANCE: <u>—</u> ohms							
SPREAD	NO. OF GROUPS: <u>96</u>	GROUP INTERVAL: <u>110'</u>	SHOTPOINT INTERVAL: <u>440'</u>	FOLD: <u>12</u>	DIRECTION OF PROGRESSION: <u>South East</u>				
	OFFSET GROUP 1: <u>5225</u>	OFFSET GROUP <u>48</u> : <u>55'</u>	OFFSET GROUP <u>49</u> : <u>55'</u>	OFFSET GROUP <u>96</u> : <u>5225</u>	LEADING GROUP: <u>96</u>				

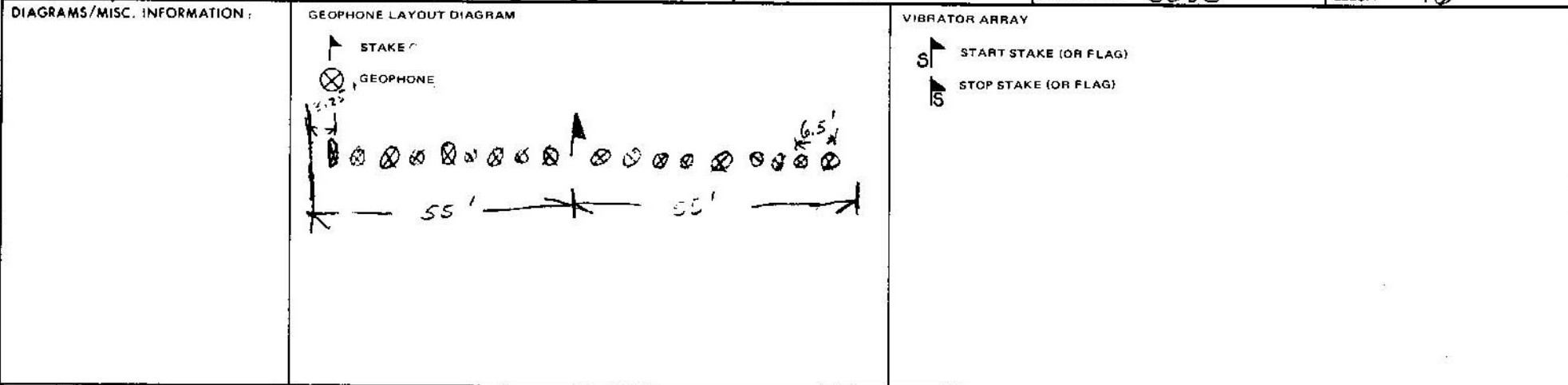

LAND SEISMIC RECORDING LOG

10F 2

	CLIENT: USGS	PROSPECT:	AREA: NPRA	LINE NO: 22/81							
	PARTY NO: 1186	INST. ENG: Hammond		DATE: 1 27 81							
INSTRUMENT (9-TRACK)	<input checked="" type="checkbox"/> 1 SYSTEM <input type="checkbox"/> 2 SYSTEMS	<input type="checkbox"/> 24 & 25-48 <input checked="" type="checkbox"/> 1-48 & 49-96	ODDS EVENS	TYPE: <input type="checkbox"/> DFS III <input type="checkbox"/> DFS IX	<input checked="" type="checkbox"/> 9 TRACK <input type="checkbox"/> 21 TRACK	FORMAT: B	<input type="checkbox"/> GAPPED <input type="checkbox"/> UNGAPPED	PACKING DENSITY:	(LO) <input type="checkbox"/> 350 BPI <input type="checkbox"/> 800 BPI	(HI) <input type="checkbox"/> 700 BPI <input checked="" type="checkbox"/> 1600 BPI	
	NO. BYTES IN HEADER REC: 228	NO. BYTES IN RECORD ID:	NO. BYTES PER SCAN: 254	RECORD NUMBERS: <input checked="" type="checkbox"/> DEC. <input type="checkbox"/> OCT.	GAIN CONSTANT: 48 db	INPUT IMPEDANCE: 2000 ohms					
CONFIGURATION (MAG TAPE)	FIELD TRACE NOS.:			AUXILIARY DATA:							
PARAMETER	RECORD LENGTH: 60 sec.	SAMPLE RATE: <input type="checkbox"/> 1 ms. <input type="checkbox"/> 4 ms. <input checked="" type="checkbox"/> 2 ms. <input type="checkbox"/> 8 ms.	GAIN MODE: <input type="checkbox"/> INITIAL <input type="checkbox"/> MANUAL <input checked="" type="checkbox"/> OFF <input type="checkbox"/> OPERATE	FILTERS: FREQ. 8 LO CUT HZ SLOPE 18	FREQ. 128 HI CUT HZ SLOPE 72	NOTCH FILTER: <input type="checkbox"/> IN <input checked="" type="checkbox"/> OUT					
DISPLAY	MODE: <input checked="" type="checkbox"/> AGC <input type="checkbox"/> FLOAT <input type="checkbox"/> DEFLOAT <input type="checkbox"/> AMPLIFIER <input type="checkbox"/> DIRECT	INITIAL GAIN: 6 db	TRIP SENS.: 36 db	POLARITY CONVENTION: POS	PRESSURE INCREASE ON GEOPHONE: <input type="checkbox"/> NEGATIVE <input checked="" type="checkbox"/> POSITIVE	NUMBERS ON MAG. TAPE: <input type="checkbox"/> DOWNBREAK <input type="checkbox"/> UPBREAK	ON DISPLAY				
CFS I	TYPE STACK:	GATE LENGTH:	RECORD REJECTION:	NOISE REDUCTION:	NOISE THRESHOLD:	CORR. SCALING:	R.C.U. NORM./ALT SW.				
SOURCE	TYPE: <input checked="" type="checkbox"/> DYNAMITE <input type="checkbox"/> VIBROSEIS <input type="checkbox"/> OTHER	PATTERN: SINGLE CHANNEL	NO. OF POSITIONS:	INLINE SPACING:	LATERAL SPACING:	STAGGER:	LENGTH:	WIDTH:	LATERAL OFFSET:		
RECEIVER	TYPE: GS 200	PATTERN: INLINE	NO. OF ELEMENTS: 18	INLINE SPACING: 6.5'	LATERAL SPACING:	STAGGER:	LENGTH:	WIDTH:	LATERAL OFFSET:		
SPREAD	NO. OF GROUPS: 96	GROUP INTERVAL: 110'	SHOTPOINT INTERVAL: 440'	FOLD: 12	DIRECTION OF PROGRESSION: N/W	OFFSET GROUP 48/96:	LEADING GROUP: 96				

DIAGRAMS/MISC. INFORMATION:

SHOTPOINT	TR. _____ TO _____		TR. _____ TO _____		SHOT				SPREAD				REMARKS:	CORR. STACK					
	REEL NO.	REC.	REEL NO.	REC.	SIZE	DEPTH	NO.	OFFSET	DIR.	CDP SWITCH	LINE GROUPS			HT.	TR 1-48	TR 48-96	HT.	TR 48-96	
412	872527	102			50	7590				1	400.1	—	428.4	418	FN 101 Narsefid				
413		103			50	7590				5	401.1	—	426.4						
414		104			50	7590				9	402.1	—	425.4						
415		105			50	7590				13	403.1	—	426.4						
416		106			50	7590				17	404.1	—	427.4						
417		107			50	7590				21	405.1	—	428.4						
418		108			50	7590				25	406.1	—	429.4						
419		109			50	7590				29	407.1	—	430.4						
420		110			50	7590				33	408.1	—	431.4						
421		111			50	7590				37	409.1	—	432.4						
422		112			50	7590				41	410.1	—	433.4						
423		113			50	7590				45	411.1	—	434.4						
424		114			50	7590				49	412.1	—	435.4		T93 REVERSED POLARITY				
425		115			50	7590				5	413.1	—	436.4	430	T89				
426		116			50	7590				9	414.1	—	437.4		T85				
427		117			50	7590				13	415.1	—	438.4						
428		118			50	7590				17	416.1	—	439.4						
429		119			50	7590				21	417.1	—	440.4						
430		120			50	7590				25	418.1	—	441.4						
431		121			50	7590				29	419.1	—	442.4						

LAND SEISMIC RECORDING LOG



CLIENT: <u>USGS</u>	PROSPECT: _____	AREA: <u>NPRA</u>	LINE NO.: <u>22/81</u>
PARTY NO.: <u>1186</u>	INST. ENG.: <u>HANNING AND</u>	<u>DAILY TESTS FN 127 - 137</u>	DATE: <u>1 DAY 28 FEB 81</u>
		<u>FN131 N/G</u> <u>FN132 N/G</u>	

SHOTPOINT	TR. 10		TR. 10		SHOT				SPREAD		REMARKS	CORR. STACK			
	REEL NO.	REC.	REEL NO.	REC.	SIZE	DEPTH	NO.	OFFSET	DIR.	COP SWITCH		LINE GROUPS	TR 1-48	TR 49-96	
	HT	REC	HT	REC									HT	REC	
437	872527	1437			50	75	90			5	425.1 — 442.4			FN138 NOISE TEST FILE	T 41 REV
438		1440			50	75	90			9	426.1 — 449.4				T 37 REV
439		1441			50	75	90			13	427.1 — 450.4				T 33
440		1442			50	75	90			17	428.1 — 451.4				T 29
441		1443			50	75	90			21	429.1 — 452.4				T 25
442		1444			50	75	90			25	430.1 — 453.4				T 21
443		1445			50	75	90			29	431.1 — 454.4				T 17
444		1447			50	75	90			33	432.1 — 455.4			FN146 N/G	T 13
445		1448			50	75	90			37	433.1 — 456.4				T 9
446		1449			50	75	90			41	434.1 — 457.4				T 5 REV
447		1450			50	75	90			45	435.1 — 458.4				
448		1451			50	75	90			49	436.1 — 459.4				
449A		1452			50	75	90			5	437.1 — 460.4	454		DOOR BUSE MISCONNECTED TO CABLE	
449B		1453			50	75	90			5	437.1 — 460.4			AT 454 ON 449 - SHOT REDRILL	
450		1454			50	75	90	330	N	9	438.1 — 461.4				
451		1455			50	75	90	300	E	13	439.1 — 462.4				
452		1456			50	75	90	180	E	17	440.1 — 463.4				
453		1457			50	75	90	160	E	21	441.1 — 464.4				
454		1458			50	75	90	160	E	25	442.1 — 465.4				
455		1459			50	75	90	160	E	29	443.1 — 466.4				
456		1460			50	75	90	160	E	33	444.1 — 467.4				
457	872527	1462		TAPES	50	75	90			37	445.1 — 468.4			FN161 MISCFIRE	
458	872528	1464		CHANGES	50	75	90			41	446.1 — 469.4			FN163 TEST FILE	
459		1465			50	75	90	1110	S	45	447.1 — 470.4				
460		1466			50	75	90	600	E	49	448.1 — 471.4				
461		1467			50	75	90			5	449.1 — 472.4	466			
462		1468			50	75	90			9	450.1 — 473.4				
463		1469			50	75	90			13	451.1 — 474.4				
464		1470			50	75	90			17	452.1 — 475.4				
465		1471			50	75	90			21	453.1 — 476.4				
466		1472			50	75	90			25	454.1 — 477.4				
467		1473			50	75	90			29	455.1 — 478.4				
468		1474			50	75	90	110	N	33	456.1 — 479.4				
469		1475			50	75	90			37	457.1 — 480.4				
470		1476			50	75	90			41	458.1 — 481.4				
471		1477			50	75	90			45	459.1 — 482.4				

LAND SEISMIC RECORDING LOG

	CLIENT: USGS	PROSPECT: HAMMOND	AREA: N PRA	LINE NO: 22/81	
	PARTY NO: 1186	INST. ENG: HAMMOND		DATE: MO 1 DAY 28 YR 81	

SHOTPOINT	TR. to		TR. to		SHOT					SPREAD		REMARKS	CORR. STACK			
	REEL NO.	REC.	REEL NO.	REC.	SIZE	DEPTH	NO.	OFFSET	DIR.	CDP SWITCH	LINE GROUPS		TR 1-28	TR 28-96	TR 96-192	TR 192-288
													HT.	REC.	HT.	REC.
472	872	178			50	75	90			49	460.1 — 483.4	466				
473		179			50	75	90			5	460.1 — 484.4	478				
474		180			50	75	90			9	462.1 — 485.4					
475		181			50	75	90			13	462.1 — 486.4					
476		182			50	75	90			17	464.1 — 487.4					
477		183			50	75	90			21	465.1 — 488.4					
478		184			50	75	90			25	466.1 — 489.4					
479		185			50	75	90			29	467.1 — 490.4					
480		186			50	75	90			33	468.1 — 491.4					
481		188			50	75	90	110	N	37	469.1 — 492.4				F/N 187 MISFIRE	
482		189			50	75	90			41	470.1 — 493.4					
483		190			50	75	90			45	471.1 — 494.4					
484		191			50	75	90			49	472.1 — 495.4					
485		192			50	75	90			5	473.1 — 496.4	490				
486		193			50	75	90			9	474.1 — 497.4					
487		194			50	75	90			13	475.1 — 498.4					
488		195			50	75	90	100	W	17	476.1 — 499.4					
489		196			50	75	90			21	477.1 — 500.4					
490		198			50	75	90	220	S	25	478.1 — 501.4				F/N 197 NG FALSE START	
491		199			50	75	90			29	479.1 — 502.4					
492		200			50	75	90			33	480.1 — 503.4					
493		201			50	75	90			37	481.1 — 504.4					
494		202			50	75	90			41	482.1 — 505.4					
495		203			50	75	90			45	483.1 — 506.4					
496		204			50	75	90			49	484.1 — 507.4					
497		205			50	75	90			5	485.1 — 508.4	502				
498		206			50	75	90			9	486.1 — 509.4					
499		207			50	75	90			13	487.1 — 510.4					
500		208			50	75	90			17	488.1 — 511.4					
501		209			50	75	90			21	489.1 — 512.4					
502		210			50	75	90	50	E	25	490.1 — 513.4				T 509+1 DEMO	
503		211			50	75	90			29	491.1 — 514.4					
504		212			50	75	90			33	492.1 — 515.4					
505		213			50	75	90			37	493.1 — 516.4					
506		214			50	75	90			41	494.1 — 517.4					
507		215			50	75	90			45	495.1 — 518.4					

LAND SEISMIC RECORDING LOG



CLIENT: USGS	PROSPECT: HAMMOND	AREA: NPRA	LINE NO.: 22/81
PARTY NO.: 1186	INST. ENG.: HAMMOND	DATE: 1 DAY 31 YR 81	
DAILY TESTS FN234 - 243			

SHOTPOINT	TR. No. _____		TR. No. _____		SHOT				SPREAD		REMARKS:	CORR. STACK				
	REEL NO.	REC.	REEL NO.	REC.	SIZE	DEPTH	NO.	OFFSET	DIR.	COP SWITCH		LINE GROUPS	TR 1-48	TR 48-96	HT.	REC.
513	872529	2415			50	75	90			9	501.1 — 524.4	517				
514		2416			50	75	90			13	502.1 — 526.4					
515		2417			50	75	90			17	503.1 — 526.4					
516		2418			50	75	90			21	504.1 — 527.4					
517		2419			50	75	90			25	505.1 — 528.4					
518		2420			50	75	90			29	506.1 — 529.4					
519		2421			50	75	90			33	507.1 — 530.4					
520		2422			50	75	90			37	508.1 — 531.4					
521		2423			50	75	90			41	509.1 — 532.4					
522		2424			50	75	90			45	510.1 — 533.4					
523		2425			50	75	90			49	511.1 — 534.4					
524		2426			50	75	90			5	512.1 — 535.4	529				
525		2427			50	75	90			9	513.1 — 536.4					
526		2428			50	75	90			13	514.1 — 537.4					
527		2429			50	75	90			17	515.1 — 538.4					
528		2430			50	75	90			21	516.1 — 539.4					
529		2431			50	75	90			25	517.1 — 540.4					
530		2432			50	75	90	600	E	29	518.1 — 541.4					
531		2433			50	75	90	600	W	33	519.1 — 542.4					
532		2434			50	75	90	500	W	37	520.1 — 543.4					
533		2435			50	75	90	400	W	41	521.1 — 544.4					
534		2436			50	75	90	400	W	45	522.1 — 545.4					
535		2437			50	75	90	220	N	49	523.1 — 546.4					
536		2438			50	75	90			5	524.1 — 547.4	541				
537		2439			50	75	90			9	525.1 — 548.4					
538		2440			50	75	90			13	526.1 — 549.4					
539		2441			50	75	90			17	527.1 — 550.4					
540		2442			50	75	90			21	528.1 — 551.4					
541		2443			50	75	90			25	529.1 — 552.4					
542		2444			50	75	90			29	530.1 — 553.4					
543		2445			50	75	90			33	531.1 — 554.4					
544		2446			50	75	90			37	532.1 — 555.4					
545		2447			50	75	90			41	533.1 — 556.4					
546		2448			50	75	90			45	534.1 — 557.4					
547		2449			50	75	90			49	535.1 — 558.4					
548		2450			50	75	90			5	536.1 — 559.4	553				

LAND SEISMIC RECORDING LOG



CLIENT: USGS	PROSPECT: HAMMOND/SNIBLE	AREA: NPRA	LINE NO.: 22/81
PARTY NO.: 1186	INST. ENG.: HAMMOND/SNIBLE	DATE: MO 2 DAY 1 YR 81	
DAILY TESTS P/N'S 294-302			



SHOTPOINT	TR. 16		TR. 16		SHOT				SPREAD		REMARKS	CORR. STACK				
	REEL NO.	REC.	REEL NO.	REC.	SIZE	DEPTH	NO.	OFFSET	DIR.	CDP SWITCH		LINE GROUPS	TR 1-48	TR 48-96	HT.	REC.
S60	872630	307			50	75/90				5	548.1 — 570.4	585				F/N 303 NOISE FILE
S61		305			50	75/90				9	549.1 — 572.4					
S62		307			50	75/90	280		5	13	550.1 — 573.4					F/N 306 MIS FIRE
S63		308			50	75/90				17	551.1 — 574.4					
S64		308			50	75/90				21	552.1 — 575.4					
S65		310			50	75/90				25	553.1 — 576.4					
S66		311			50	75/90				29	554.1 — 577.4					
S67		312			50	75/90				33	555.1 — 578.4					
S68		313			50	75/90				37	556.1 — 579.4					
S69		314			50	75/90				41	557.1 — 580.4					
S70		315			50	75/90				45	558.1 — 581.4					
S71		316			50	75/90				49	559.1 — 582.4					
S72		317			50	75/90				5	560.1 — 583.4	572				
S73		318			50	75/90				9	561.1 — 584.4					
S74		319			50	75/90				13	562.1 — 585.4					
S75		320			50	75/90				17	563.1 — 586.4					
S76		321			50	75/90				21	564.1 — 587.4					
S77		322			50	75/90				25	565.1 — 588.4					
S78		323			50	75/90				29	566.1 — 589.4					
S79		325			50	75/90				33	567.1 — 590.4					F/N 324 MIS FIRE
S80		326			50	75/90				37	568.1 — 591.4					
S81		327			50	75/90				41	569.1 — 592.4					
S82		328			50	75/90				45	570.1 — 593.4					
S83		329			50	75/90				49	571.1 — 594.4					
S84		330			50	75/90				5	572.1 — 595.4	589				
S85		331			50	75/90				9	573.1 — 596.4					NO SPS
S86		332			50	75/90				13	574.1 — 597.4					
S87		333			50	75/90				17	575.1 — 598.4					
S88		334			50	75/90				21	576.1 — 599.4					
S89		335			50	75/90				25	577.1 — 600.4					T 597+2 DEAD
S90		336			50	75/90				29	578.1 — 601.4					
S91		337			50	75/90				33	579.1 — 602.4					
S92		338			50	75/90				37	580.1 — 603.4					
S93		339			50	75/90				41	581.1 — 604.4					
S94		340			50	75/90				45	582.1 — 605.4					
S95		341			50	75/90				49	583.1 — 606.4					

LAND SEISMIC RECORDING LOG



CLIENT: USGS	PROSPECT: 	AREA: NPRA	LINE NO. 22/81
PARTY NO. 1186	INST. ENG. HAMMOND/SWIBLE		DATE: 2 DAY 1 TRCL

SHOTPOINT	TR. 1		TR. 2		SHOT				DIR	CDP SWITCH	SPREAD		REMARKS	CORE STACK			
	REEL NO.	REC.	REEL NO.	REC.	SIZE	DEPTH	NO.	OFFSET			LINE GROUPS	TR 1-48		TR 48-96	TR 1-48	TR 48-96	
596	872530	342			50	7500				5	584.1	607.4	601				
597		343			50	7500				9	585.1	608.4					
598		344			50	7500				13	586.1	609.4					
599	872530	345			50	7500				17	587.1	610.4					
600	872531	347			50	7500				21	588.1	611.4					
601		348			50	7500				25	589.1	612.4					
602		349			50	7500				29	590.1	613.4					
603		350			50	7500				33	591.1	614.4					
604		352			50	7500				37	592.1	615.4					
605		353			50	7500				41	593.1	616.4					
606		354			50	7500				45	594.1	617.4					
607		355			50	7500	120	S		49	595.1	618.4					
608		356			50	7500				5	596.1	619.4	615				
609		357			50	7500				9	597.1	620.4					
610		358			50	7500				13	598.1	621.4					
611		359			50	7500				17	599.1	622.4					
612		360			50	7500				21	600.1	623.4					
613		361			50	7500				25	601.1	624.4					
614		362			50	7500				29	602.1	625.4					
615		363			50	7500				33	603.1	626.4					
616		364			50	7500				37	604.1	627.4					
617		365			50	7500				41	605.1	628.4					
618		366			50	7500				45	606.1	629.4					
619		367			50	7500				49	607.1	630.4					
620		368			50	7500				5	608.1	631.4	625				
621		369			50	7500	110	S		9	609.1	632.4					
622		370			50	7500				13	610.1	633.4					
623		371			50	7500	160	E		17	611.1	634.4					
624		372			50	7500				21	612.1	635.4					
625		373			50	7500				25	613.1	636.4					
626		374			50	7500				29	614.1	637.4					
627		375			50	7500				33	615.1	638.4					
628		376			50	7500				37	616.1	639.4					
629		377			50	7500				41	617.1	640.4					
630		378			50	7500				45	618.1	641.4					
631		379			50	7500				49	619.1	642.4	637				

M/N 346 TEST FILE

M/N 351 TEST FILE

T93 REVERSED POLARITY

T66 DEAD

LAND SEISMIC RECORDING LOG



CLIENT: USGS	PROSPECT: HAMMOND/SNIGLE	AREA: NPRA	LINE NO: 22181
PARTY NO: 1186	INST. ENG: DAILY TESTS FN392-400		DATE: 2 DAY 2 YR 81

SHOTPOINT	TR 10		TR 10		SHOT				SPREAD		REMARKS	CORR. STACK				
	REEL NO.	REC.	REEL NO.	REC.	SIZE	DEPTH	NO.	OFFSET	DIR.	CDP SWITCH		LINE GROUPS	TR 1-48	TR 49-96	TR 97-144	TR 145-192
	HT.	REC.	HT.	REC.									HT.	REC.	HT.	REC.
649		402			50	175	90			5	632.1 — 655.4	649				
645		403			50	175	90			9	633.1 — 656.4					
646		404			50	175	90			13	634.1 — 657.4					
647		405			50	175	90			17	635.1 — 658.4					
648	8723531	406		TR 10	50	175	90			21	636.1 — 659.4					
649	8723532	408		CHANGE	50	175	90			25	637.1 — 660.4					
650		409			50	175	90			29	638.1 — 661.4					
651		410			50	175	90			33	639.1 — 662.4					
652		411			50	175	90			37	640.1 — 663.4					
653		412			50	175	90			41	641.1 — 664.4					
654		413			50	175	90			45	642.1 — 665.4					
655		414			50	175	90			49	643.1 — 666.4					
656		415			50	175	90			5	644.1 — 667.4	661				
657		416			50	175	90	11.0	W	9	645.1 — 668.4					
658		417			50	175	90	60	W	13	646.1 — 669.4					
659		418			50	175	90			17	647.1 — 670.4					
660		420			50	175	90			21	648.1 — 671.4					
661		421			50	175	90			25	649.1 — 672.4					
662		422			50	175	90			29	650.1 — 673.4					
663		423			50	175	90			33	651.1 — 674.4					
664		424			50	175	90			37	652.1 — 675.4					
665		425			50	175	90			41	653.1 — 676.4					
666		426			50	175	90			45	654.1 — 677.4					
667		427			50	175	90			49	655.1 — 678.4					
668		428			50	175	90			5	656.1 — 679.4	673				
669		429			50	175	90			9	657.1 — 680.4					
670		430			50	175	90			13	658.1 — 681.4					
671		431			50	175	90			17	659.1 — 682.4					
672		432			50	175	90			21	660.1 — 683.4					
673		433			50	175	90			25	661.1 — 684.4					
674		434			50	175	90			29	662.1 — 685.4					
675		435			50	175	90			33	663.1 — 686.4					
676		436			50	175	90			37	664.1 — 687.4					
677		437			50	175	90			41	665.1 — 688.4					
678		438			50	175	90			45	666.1 — 689.4					
679		439			50	175	90			49	667.1 — 690.4					

LAND SEISMIC RECORDING LOG



CLIENT: **USGS**
 PARTY NO.: **1186**

PROSPECT: **AMMOND/SABLE**
 INST. ENG.: **AMMOND/SABLE**

AREA: **NPRA**



LINE NO.: **22/81**
 DATE: **22** **81**
 MO: **2** DAY: **2** YR: **81**



SHOTPOINT EIT	TR 10		TR 10		SHOT			DIR.	CDP SWITCH	SPREAD		REMARKS	CORR. STACK			
	REEL NO.	REC.	REEL NO.	REC.	SIZE	DEPTH	NO.			OFFSET	LINE GROUPS		TR 1-48	TR 48-96	REC.	REC.
680	872533	440			50	75	20		5	668.1	691.4	685				
681		441			50	75	20		9	669.1	692.4					
682		442			50	75	20		13	670.1	693.4					
683		443			50	75	20		17	671.1	694.4					
684		444			50	75	20		21	672.1	695.4					
685		445			50	75	20		25	673.1	696.4					
686		446			50	75	20		29	674.1	697.4					
687		447			50	75	20		33	675.1	698.4					
688		448			50	75	20		37	676.1	699.4					
689		449			50	75	20		41	677.1	700.4					
690		450			50	75	20		45	678.1	701.4					
691		451			50	75	20		49	679.1	702.4					
692		452			50	75	20		5	680.1	703.4	697				
693		453			50	75	20		9	681.1	704.4					
694		454			50	75	20		13	682.1	705.4					
695		455			50	75	20		17	683.1	706.4					
696		456			50	75	20		21	684.1	707.4					
697		457			50	75	20		25	685.1	708.4					
698		458			50	75	20		29	686.1	709.4					
699		459			50	75	20		33	687.1	710.4					
700		460			50	75	20		37	688.1	711.4					
701	872533	461			50	75	20		41	689.1	712.4					
702	872533	463			50	75	20		45	690.1	713.4					
703		464			50	75	20		49	691.1	714.4					
704		465			50	75	20		5	692.1	715.4	709				
705		466			50	75	20		9	693.1	716.4					
706		467			50	75	20		13	694.1	717.4					
707		468			50	75	20		17	695.1	718.4					
708		469			50	75	20		21	696.1	719.4					
709		470			50	75	20		25	697.1	720.4					
710		471			50	75	20		29	698.1	721.4					
711		472			50	75	20		33	699.1	722.4					
712		473			50	75	20		37	700.1	723.4					
713		474			50	75	20		41	701.1	724.4					
714		475			50	75	20		45	702.1	725.4					
715		476			50	75	20		49	703.1	726.4					

FN 462 TEST FILE

LAND SEISMIC RECORDING LOG

	CLIENT: USGS	PROSPECT:	AREA: NPRA	LINE NO: 22/81	
	PARTY NO: 1186	INST. ENG.: HAMMOND/SNIBLE		DATE: 2 DAY 2 TR 81	

SHOTPOINT	TR		TR		SHOT					DR.	SPREAD		REMARKS	CORR. STACK			
	NO.	REEL NO.	NO.	REEL NO.	SIZE	DEPTH	NO.	OFFSET	CDP SWITCH		LINE GROUPS	YR 1-28		YR 48-96			
												HT		REC.	HT	REC.	
716	12	72533	17	2223	50	7590	1	1	5	704.1	727.4	721					
717		478			50	7590			9	705.1	728.4						
718		479			50	7590			13	706.1	729.4						
719		480			50	7590			17	707.1	730.4						
720		481			50	7590			21	708.1	731.4					T92 DEAD	
721		482			50	7590			25	709.1	732.4						
722		483			50	7590			29	710.1	733.4						
723		484			50	7590			33	711.1	734.4						
724		485			50	7590			37	712.1	735.4					T72 DEAD	
725		486			50	7590			41	713.1	736.4						
726		487			50	7590			45	714.1	737.4						
727		488			50	7590			49	715.1	738.4						
728		489			50	7590			41	716.1	739.4	724				T56 DEAD	
729																	
730																	

