

CLIENT		PARTY NO.	PROSPECT	COUNTY	STATE	COUNTRY	LEFT STORAGE	ARRIVED FIELD	LEFT FIELD	ARRIVED STORAGE	DATE	OBSERVER	PAGE																															
U.S. NAVY		1184	NPA-4	NORTH SLOPE	ALASKA	USA.	7:00	2:30	9:30	10:00	APR 3/75	Vic Donald	1 of 2																															
LINE	PROFILE	IDENTIFICATION		SHOT CAL	PLAY BACK	TIME	SHOT				SPREAD				TAPE			GAIN					FILTERS			REMARKS																		
		REEL NUMBER	FILE NUMBER				SIZE	TOP BOT.	NO CAPS	CODE	S.P. OFFSET	NO. 1 DIR.	CODE	SEIS. OFFSET	SEIS. OFFSET	CDP SWITCH	SETUP	SAMPLE RATE MS	RECORD LENGTH	PARITY ERRORS	MODE	INITIAL GAIN (DB)					FINAL GAIN DB	RELEASE RATE	TRIP DELAY	HIGH CUT FREQ.	LOW CUT	NOTCH IN OUT												
37	1	523222	1373	A	MAN		55	82/90	2	①		N	①	10'	14'	1/4	①	✓	6SEC	OP	54	54	54	48	48	36	120	FAST	5/2	124	8'	36	OUT	START OF NEW LINE WITH 24 GROUP TAPS										
	2		1374				55	67/75	2												36	48	48	54	54																			
	3		1375				55	67/75	2																																			
	4		1376				55	67/75	2																																			
	5		1377				55	67/75	2																																			
	6		1400				55	67/75	2																																			
	7		1401				55	67/75	2																																			
	8		1402				55	67/75	2																																			
	9		1403				55	67/75	2																																			
	10		1404				55	67/75	2																																			
	11		1405				55	67/75	2																																			
	12		1406				55	67/75	2																																			
	13		1407				55	67/75	2																																			
	14		1411				55	67/75	2																																			
	15		1412				55	67/75	2																																			
	16		1413				55	67/75	2																																			
	17		1414				55	67/75	2																																			
	18		1415				55	67/75	2																																			
Tape Change																																												
	19	523223	1416				55	67/75	2																																			
	20		1417				55	67/75	2																																			
	21		1420				55	67/75	2																																			
	22		1421				55	67/75	2																																			
	23		1422	LAKE			55	67/75	2																																			
	24		1423				55	67/75	2																																			
	25		1424	LAKE			55	67/75	2																																			
	26		1425				55	67/75	2																																			
	27		1426				55	67/75	2																																			

TA#37 REAR

WEAK SHOT

TA#2 SHORTED

SEISMOMETER AND SPREAD INFORMATION

CODE	SEIS. TYPE	NO./GP.	INT.	GROUP PATTERN	GP. INT.	SPREAD PATTERN
①		9	12'	INLINE	330'	48 GROUPS INLINE 24/24 SPLIT NO GAP

SHOT CONFIGURATION

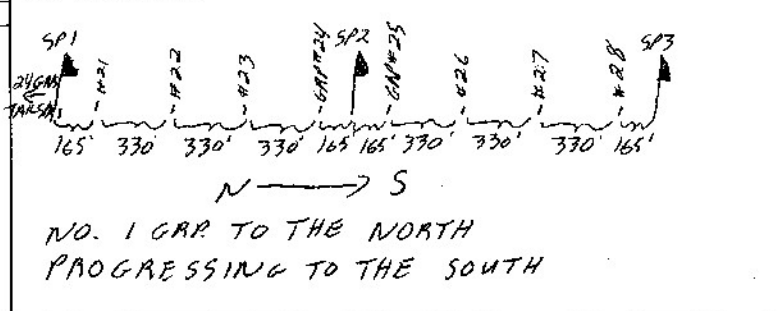

DFS III SYSTEM PARAMETERS:

GAIN CONSTANT 30 DB
 UPPER SET LIMIT 62.5 %
 LOWER SET LIMIT 18 %
 FORMAT TYPE:
 9 TRACK 21 TRACK
 GALVO LEVEL:
 1-24 21 DB AUX 15 DB
 OTHER:

MISCELLANEOUS INFORMATION:

REC# 1361-1370 DAD TEST
 REC# 1371 TEST TA
 REC# 1372 - MISSFIRE
 REC# 1410 - PULBE TEST

CLIENT U.S. NAVY	PARTY NO. 1184	PROSPECT NPA-4	COUNTY NORTH SLOPE	STATE ALASKA	COUNTRY USA	LEFT STORAGE 700	ARRIVED FIELD 730	LEFT FIELD 600	ARRIVED STORAGE 700	DATE APR 7/75	OBSERVER Vic Donald	PAGE 1 of 2
---------------------	-------------------	-------------------	-----------------------	-----------------	----------------	---------------------	----------------------	-------------------	------------------------	------------------	------------------------	----------------

LINE	PROFILE	IDENTIFICATION		SHOT CAL	PLAY BACK	TIME	SHOT				SPREAD				TAPE			GAIN						FILTERS			REMARKS									
		REEL NUMBER	FILE NUMBER				SIZE	TOP	NO CAPS	CODE	S.P. OFFSET	NO. 1 DIR.	CODE	S. S. OFFSET	SIS DEPTH	CDP SWITCH	SETUP	SAMPLE RATE MS	RECORD LENGTH	PARITY ERRORS	MODE	INITIAL GAIN (DB)						FINAL GAIN DB	RELEASE RATE	TRIP DELAY	HIGH CUT FREQ.	LOW CUT	NOTCH			
								BOT.										1	2	4		1-4/24	5-8	9-12	13-16	17-20		21-24				FREQ.	SLOPE	IN	OUT	
37	62	52322	1514	19	BAW		55	82/90	2	⊙		N	10	12	1/5	⊙	✓	6522	OP	54	54	54	48	48	36	120	EAST	384	124	8	36	OUT				
	63		1515				55	82/90	2						13	1/4																				
	64		1516				55	82/90	2						12	1/3																				
	65		1517				55	82/90	2						13	1/17																				
	66		1520				55	82/90	2						12	1/21																				
	67		1521				55	82/90	2						12	1/25																				
	68		1522				55	82/90	2						12	1/29																				
	69		1523				55	82/90	2						12	1/33																				
	70		1524				55	82/90	2						13	1/37																				
	71		1525				55	12/50	2						10	1/41																				
	72		1526				55	82/90	2						12	1/45																				
	73		1527				50	73/90	2			70°N			12	1/49																				
	74		1531				55	67/75	2						12	1/5	⊙																			
	75		1532				55	67/75	2						12	1/9																				
	76		1533				55	67/75	2						12	1/13																				
	77		1534				55	67/75	2						12	1/17																				
	78		1535				55	67/75	2						12	1/21																				
	79		1536				55	67/75	2						-	1/25																				
	80		1537				55	67/75	2						10	1/29																				
	81		1540				55	67/75	2						11	1/33																				
	82		1541				55	67/75	2						12	1/37																				
	83		1542				55	82/90	2						16	1/41																				
	84		1543				55	67/75	2						12	1/45																				
	85		1544				55	82/90	2						13	1/1																				
	86		1545				55	82/90	2						16	1/5																				
	87		1546				55	82/90	2						16	1/9																				
	88		1547				55	82/90	2						17	1/13																				
	89		1550				55	82/90	2						16	1/17																				

SEISMOMETER AND SPREAD INFORMATION					
CODE	SEIS. TYPE	NO./GP.	INT.	GROUP PATTERN	SPREAD PATTERN
⊙		9	12'	INLINE	330' 48 GROUPS INLINE 24/24 SPLIT NO GAP

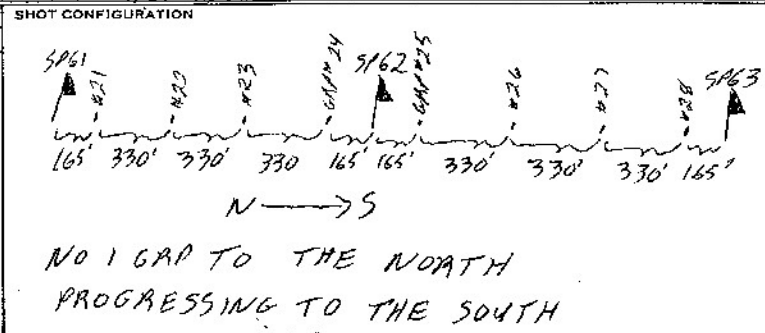

DFS III SYSTEM PARAMETERS:

GAIN CONSTANT 30 DB
 UPPER SET LIMIT 62.5 %
 LOWER SET LIMIT 18 %
 FORMAT TYPE:
 9 TRACK 21 TRACK
 GALVO LEVEL:
 1-24 21 DB AUX 15 DB
 OTHER:

MISCELLANEOUS INFORMATION:

REC# 1503 - 1512 DRD TEST
 REC# 1513 TEST TB.
 REC# 1530 PULSE TEST

CLIENT U.S. NAVY	PARTY NO. 1184	PROSPECT NAA-4	COUNTY NORTH SLOPE	STATE ALASKA	COUNTRY U.S.A.	LEFT STORAGE 7:00	ARRIVED FIELD 7:30	LEFT FIELD 9:30	ARRIVED STORAGE 10:00	DATE APR 3/75	OBSERVER Vic Donald	PAGE 1 of 2
----------------------------	--------------------------	--------------------------	------------------------------	------------------------	--------------------------	-----------------------------	------------------------------	---------------------------	---------------------------------	-------------------------	-------------------------------	-----------------------

LINE	PROFILE	IDENTIFICATION		SHOT	SIZE	SHOT		SPREAD				TAPE			GAIN						FILTERS			REMARKS											
		REEL NUMBER	FILE NUMBER			NO CAPS	CODE	S.P. OFFSET	NO. 1 DIR.	CODE	SIZE	US	SWITCH	SETUP	SAMPLE RATE MS	RECORD LENGTH	PARITY ERRORS	MODE	INITIAL GAIN (DB)						RELEASE RATE	TRIP DELAY	HIGH CUT FREQ.	LOW CUT	NOTCH						
		CAL	PLAY BACK	TIME	TOP	BOT	NO. 2 DIR.	CODE	SIZE	US	SWITCH	SETUP	1	2	4	1-4/24	5-8	9-12	13-16	17-20	21-24	FINAL GAIN DB			FREQ.	SLOPE	IN	OUT							
37	1	523222	1373	A	RAW											650C	OP.	54	54	54	48	48	36	120	FAST	5.2	124	8	36	OUT	START OF NEW LINE WITH 24 GROUP TAILSPREAD				
	2		1374																																
	3		1375																																
	4		1376																																
	5		1377																																
	6		1400																														TA#37 DEAD		
	7		1401																																
	8		1402																																
	9		1403																																
	10		1404																																
	11		1405																																
	12		1406																																
	13		1407																																
	14		1411																																
	15		1412																																
	16		1413																															WEAK SHOT	
	17		1414																																
	18		1415																																
				TAPES CHANGE																															
	19	523223	1416																																
	20		1417																																
	21		1420																																
	22		1421																																
	23		1422	LAKE																															
	24		1423																																
	25		1424	LAKE																															
	26		1425																																
	27		1426																															TR#2 SHORTED	

SEISMOMETER AND SPREAD INFORMATION					
CODE	SEIS. TYPE	NO./GP.	INT.	GROUP PATTERN	SPREAD PATTERN
①		9	12'	INLINE	330' 48 GROUPS INLINE 24/24 SPLIT NO GAP

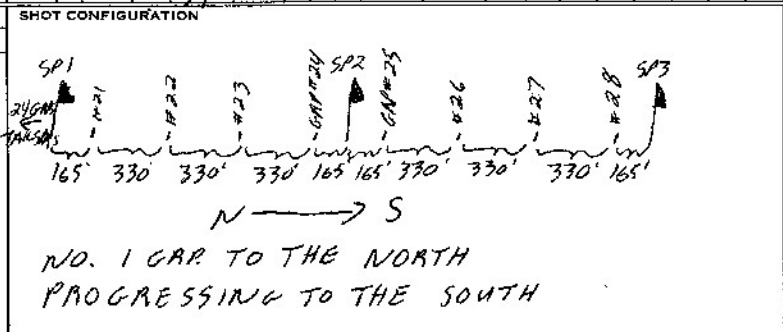

DFS III SYSTEM PARAMETERS:

GAIN CONSTANT 30 DB
 UPPER SET LIMIT 62.5 %
 LOWER SET LIMIT 18 %
 FORMAT TYPE:
 9 TRACK 21 TRACK
 GALVO LEVEL:
 1-24 21 DB AUX 15 DB
 OTHER:

MISCELLANEOUS INFORMATION:

REC# 1361-1370 DAD TEST
 REC# 1371 TEST TA
 REC# 1372 - MISSFIRE
 REC# 1410 - PULSE TEST

CLIENT U.S. NAVY	PARTY NO 1184	PROSPECT NPR-4	COUNTY	STATE ALASKA	COUNTRY	LEFT STORAGE	ARRIVED FIELD	LEFT FIELD	ARRIVED STORAGE	DATE APR 3/75	OBSERVER Vic Donald	PAGE 1051
----------------------------	-------------------------	--------------------------	--------	------------------------	---------	--------------	---------------	------------	-----------------	-------------------------	-------------------------------	---------------------

LINE	PROFILE	IDENTIFICATION		SHOT CAL	PLAY BACK	TIME	SHOT		NO CAPS	CODE	S.P. OFFSET	NO. 1 DIR.	CODE	SPREAD		CDP SWITCH	SETUP	TAPE		GAIN						FILTERS		REMARKS						
		FILE NUMBER	REEL NUMBER				SIZE	TOP						BOT	NO. 2 DIR.			CODE	RECORD LENGTH	PARITY ERRORS	MODE	INITIAL GAIN (DB)							LOW CUT FREQ.	SLOPE	NOTCH IN/OUT			
37	34A	EXP.1	1001	A	RAW		50'	57.75	2	0	35'E	N	0	10'	21	1/37	✓	65EC	DP.	54	54	54	48	48	36	720	FAST	AUTO 640	124	8	36	OUT	- DYNAMITE (GEO-GEL) - PRIMACORD - PRIMACORD	
	34B		1002	B			330'	6"	2		10'W			10'	8	1/37																		
	34C		1003	C			660'	6"	2		18'W			10'	8	1/37																		

SEISMOMETER AND SPREAD INFORMATION

CODE	SEIS. TYPE	NO./GP.	INT.	GROUP PATTERN	GP. INT.	SPREAD PATTERN
0		9	12'	INLINE	330	48 GROUPS INLINE 24/24 SPLIT NO GAP

SHOT CONFIGURATION

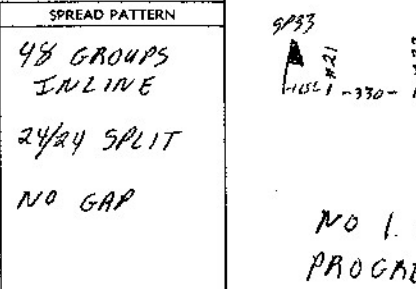

DFS III SYSTEM PARAMETERS:

GAIN CONSTANT 30 DB
 UPPER SET LIMIT 62.5 %
 LOWER SET LIMIT 18 %
 FORMAT TYPE:
 9 TRACK 21 TRACK
 GALVO LEVEL:
 1-24 21 DB AUX 15 DB
 OTHER:

MISCELLANEOUS INFORMATION:

EXPERIMENTAL BETWEEN
 50 lbs OF GEO-GEL - 330' OF PRIMACORD
 AND 660' PRIMACORD

CLIENT U.S. NAVY	PARTY NO. 1184	PROSPECT NPA-4	COUNTY MOCHA SLOPE	STATE ALASKA	COUNTRY USA	LEFT STORAGE 700	ARRIVED FIELD 800	LEFT FIELD 630	ARRIVED STORAGE 730	DATE APRIL 6/75	OBSERVER Vic Donald	PAGE 1089
----------------------------	--------------------------	--------------------------	------------------------------	------------------------	-----------------------	----------------------------	-----------------------------	--------------------------	-------------------------------	---------------------------	-------------------------------	---------------------

LINE	PROFILE	IDENTIFICATION		SHOT CAL.	PLAY BACK	TIME	SHOT			SPREAD					TAPE				GAIN						FILTERS		REMARKS																
		REEL NUMBER	FILE NUMBER				SIZE	TOP	NO CAPS	CODE	S.P. OFFSET	NO. 1 DIR.	CODE	4 OFFSET	SUB DEPTH	CDP SWITCH	SETUP	SAMPLE RATE MS	RECORD LENGTH	PARITY ERRORS	MODE	INITIAL GAIN (DB)						FINAL GAIN DB	RELEASE RATE	TRIP DELAY	HIGH CUT FREQ.	LOW CUT FREQ.	SLOPE	NOTCH IN OUT									
		1-4	2				4	1-4	5-8	9-12	13-16	17-20	21-24	1-4	5-8	9-12	13-16	17-20	21-24	1-4	5-8	9-12	13-16	17-20	21-24																		
37	38	523223	1452	A	RAM		55	67/75	2	0		N	0	10'	0	1/2	10	6SEC	OP	54	54	54	48	48	36	120	FAST	640	124	8	36	041	UH. JUG SHORTED										
	39		1453				55	67/75	2							12	1/4																										
	40		1454				50	57/75	2							12	1/3																										
	41		1455				50	57/75	2							12	1/7																										
	42		1456				50	57/75	2							12	1/21																										
	43		1457				50	57/75	2							10	1/25										512																
	44		1460				55	67/75	2		165N			25'	12	1/29																											
	45		1461				55	67/75	2					10'	12	1/33																											
	46		1462				55	67/75	2		75N			20'	16	1/37																											
	47		1463				55	82/90	2					10'	12	1/41																											
	48		1464				55	67/75	2		330'S				12	1/45																											
	49		1465				55	82/90	2						12	1/49																											
	50		1466				55	67/75	2						13	1/5																											
	51		1470				55	82/90	2						13	1/4											416																
	52		1471				55	82/90	2						13	1/13																											
	53		1472				55	82/90	2						13	1/17																											
	54		1473				55	82/90	2						13	1/21																											
	55		1474				55	82/90	2						13	1/25																											
	56		1475				55	82/90	2						13	1/29																											
	57		1476				55	82/90	2						17	1/33																											
	58		1477				55	82/90	2						18	1/37																											
	59		1500				55	82/90	2		60'S				13	1/41											480																
TAPE CHANGE																																											
	60	523224	1501	A			55	82/90	2						13	1/45																											
	61		1502				55	82/90	2						13	1/49												256															

SEISMO METER AND SPREAD INFORMATION						SHOT CONFIGURATION				DFS III SYSTEM PARAMETERS:				MISCELLANEOUS INFORMATION:							
CODE ①	SEIS. TYPE	NO./GP.	INT.	GROUP PATTERN	GP. INT.	SPREAD PATTERN				SP37 N → S NO 1 GRP TO THE NORTH PROGRESSING TO THE SOUTH				GAIN CONSTANT 30 DB UPPER SET LIMIT 62.5 % LOWER SET LIMIT 18 % FORMAT TYPE: <input type="checkbox"/> 9 TRACK <input checked="" type="checkbox"/> 21 TRACK GALVO LEVEL: 1-24 21 DB AUX 15 DB OTHER:				REC # 1441 - 71450 DRD TEST REC # 1451 TEST T.B. REC # 1466 PULSE TEST JUG TRACK DOWN FOR 2 HOURS TIMING LINES ON CAMERA STILL COUNT 90 MILS INSTEAD OF 100 MIL ONCE IN AWHILE.			

CLIENT: U.S. NAVY PARTY NO: 1184 PROSPECT: NPA-4 COUNTY: NORTH SLOPE STATE: ALASKA COUNTRY: USA LEFT STORAGE: 700 ARRIVED FIELD: 730 LEFT FIELD: 930 ARRIVED STORAGE: 1000 DATE: APRIL 3/75 OBSERVER: Vic Donald PAGE: 7082

IDENTIFICATION				SHOT				SPREAD				TAPE				GAIN				FILTERS				REMARKS											
LINE	PROFILE	REEL NUMBER	FILE NUMBER	SHOT CAL.	PLAY BACK	TIME	SIZE	TOP BOT.	NO. CAPS	CODE	S.P. OFFSET	NO. DIR.	CODE	S.P. SEIS. OFFSET	TIME	CDP SWITCH	SETUP	SAMPLE RATE MS	RECORD LENGTH	PARITY ERRORS	MODE	INITIAL GAIN (DB)				FINAL GAIN DB	RELEASE RATE	TRIP DELAY	HIGH CUT FREQ.	LOW CUT		NOTCH			
																		1	2	4		1-4/24	5-8		9-12	13-16	17-20	21-24			FREQ.	SLOPE	IN	OUT	
37	28	523223	1427	A	APM		55	6775	2	0		N	0	10	14	13	13	V	6SEC		OP						120	FRS	640	124	8	36	OUT		
	29		1430				55	6775	2						14	17																			
	30		1431				55	6775	2						13	21																			
	31		1432				55	6775	2		165'S				14	25																			
	32		1433				55	6775	2		1				14	29																			
	33		1434				55	6775	2		330NW			200	29	33																		-TR#24 DEAD	
	34		1435				50	5775	2		165'S				28	37																			
	35		1436				55	6775	2		150W				14	41																			
	36		1437				55	6775	2						13	45																			
	37		1440				55	6775	2						13	44																			TR#48 DEAD

NB 3 EXP SHOTS TOOK ON SEPARATE TAPE + OBSERVER LOG

TR#24 DEAD

TR#48 DEAD

SEISMOMETER AND SPREAD INFORMATION

CODE SEIS. TYPE NO./GP. INT. GROUP PATTERN GP. INT. SPREAD PATTERN

SHOT CONFIGURATION

DFS III SYSTEM PARAMETERS:

GAIN CONSTANT _____ DB
 UPPER SET LIMIT _____ %
 LOWER SET LIMIT _____ %
 FORMAT TYPE:
 9 TRACK 21 TRACK
 GALVO LEVEL:
 1-24 _____ DB AUX _____ DB
 OTHER:

MISCELLANEOUS INFORMATION:

IDENTIFICATION		SHOT				SPREAD										TAPE	GAIN								FILTERS		REMARKS											
LINE	PROFILE	REEL NUMBER	FIVE NUMBER	SHOT CAL.	PLAY BACK	TIME	SIZE	TOP BOT.	NO CAPS	CODE	S.P. OFFSET	NO. 1 DIR.	CODE	S. SEIS. OFFSET	NO. OF DIR. G.	CDP SWITCH	SETUP	SAMPLE RATE MS	RECORD LENGTH	PARITY ERRORS	MODE	INITIAL GAIN (DB)								FINAL GAIN DB	RELEASE RATE	TRIP DELAY	HIGH CUT FREQ.	LOW CUT		NOTCH		
																						1	2	4	1-4/24	5-8		9-12	13-16	17-20	21-24	FREQ.		SLOPE		IN	OUT	
37	90	533224	1551	A	RAW		55	78/95	2	0		N	0	10	13	1/21	3	✓	696C	OP	54	54	54	48	48	36	120	FAST	124	8	36	OUT	-NO UPHOLE					
	91		1552				55	82/90	2													36	48	54	54	54												
	92		1553				55	83/90	2																													
	93		1554				55	83/90	2																													
	94		1555				55	82/90	2																													
	95		1556				55	83/90	2																													
	96		1557				55	83/90	2																													
	97		1560				55	83/90	2																													

SEISMOMETER AND SPREAD INFORMATION

CODE	SEIS. TYPE	NO./GP.	INT.	GROUP PATTERN	GP. INT.	SPREAD PATTERN

SHOT CONFIGURATION

SAME AS PAGE 1 OF 2

DFS III SYSTEM PARAMETERS:

GAIN CONSTANT _____ DB
 UPPER SET LIMIT _____ %
 LOWER SET LIMIT _____ %
 FORMAT TYPE:
 9 TRACK 21 TRACK
 GALVO LEVEL:
 1-24 _____ DB AUX _____ DB
 OTHER:

MISCELLANEOUS INFORMATION:

CLIENT	PARTY NO.	PROSPECT	COUNTY	STATE	COUNTRY	LEFT STORAGE	ARRIVED FIELD	LEFT FIELD	ARRIVED STORAGE	DATE	OBSERVER	PAGE
U.S. NAVY	1184	NPA-4	NORTH SLOPE	ALASKA	USA	700	730	5 00	600	APRIL 8/75	W. Donald	1082

LINE	IDENTIFICATION			SHOT	CAL.	PLAY BACK	TIME	SHOT				SPREAD				TAPE				GAIN						FILTERS			REMARKS							
	PROFILE	REEL NUMBER	FIVE NUMBER					SIZE	TOP	NO CAPS	CODE	S.P. OFFSET	NO. 1 DIR.	CODE	W. S. OFFSET	E. S. OFFSET	SWITCH	SETUP	SAMPLE RATE MS	RECORD LENGTH	PARITY ERRORS	MODE	INITIAL GAIN (DB)							FINAL GAIN DB	RELEASE RATE	TRIP DELAY	HIGH CUT FREQ.	LOW CUT	NOTCH	
																			1	2	4		1-4/24	5-8	9-12	13-16	17-20	21-24			FREQ.	SLOPE	IN	OUT		
27	98	523224	1572	55	67/95	2				N	0	16'	13	1/5	0	✓	6960	OP		54	54	54	48	48	36	120	EAST	AUTO 576	124	8	36	OUT				
	99		1573	55	82/90	2								17	1/9					36	48	48	54	54	50											
	100		1574	55	82/90	2								16	1/13																					
	101		1575	55	82/90	2								13	1/7																					
	102		1576	55	82/90	2								13	1/21																					
TAPPE CHANGE																																				
	103		1577	55	82/90	2								12	1/25																					
	104		1600	55	82/90	2								13	1/29																					
	105		1601	55	82/90	2								12	1/33																					
	106		1602	55	82/90	2								12	1/37																					
	107		1603	55	82/90	2								16	1/41																					
	108		1604	55	82/90	2								15	1/45																					
	109		1605	55	82/90	2								16	1/49																					
	110		1607	55	42/50	2								17	1/5	Ⓚ																				
	111		1610	55	82/90	2								15	1/9																					
	112		1611	55	82/90	2								13	1/13																					
	113		1612	55	82/90	2								16	1/17																					
	114		1613	55	82/90	2								16	1/21																					
	115		1614	55	82/90	2								13	1/25																					
	116		1615	55	82/90	2								14	1/29																					
	117		1616	55	82/90	2								17	1/33																					
	118		1617	55	82/90	2								14	1/37																					
	119		1620	55	82/90	2								17	1/41																					
	120		1621	55	82/90	2								14	1/45																					
	121		1622	55	82/90	2								13	1/49																					
	122		1623	55	82/90	2								15	1/5																					
	123		1624	55	82/90	2								16	1/9																					
	124		1625	55	82/90	2								14	1/13																					

SEISMOMETER AND SPREAD INFORMATION					
CODE	SEIS. TYPE	NO./GP.	INT.	GROUP PATTERN	SPREAD PATTERN
Ⓚ		1	13'	INCLINE	48 GROUPS INCLINE 24/24 SPLIT NO GAP

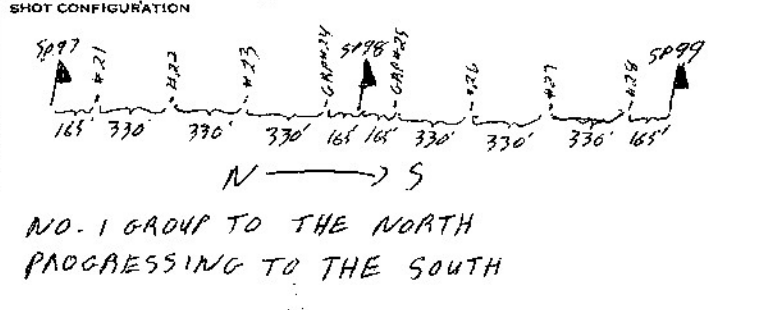

DFS III SYSTEM PARAMETERS:

GAIN CONSTANT	30	DB
UPPER SET LIMIT	62.5	%
LOWER SET LIMIT	18	%
FORMAT TYPE:		
<input type="checkbox"/>	9 TRACK	<input checked="" type="checkbox"/> 21 TRACK
GALVO LEVEL:		
1-24	21	DB AUX 15 DB
OTHER:		

MISCELLANEOUS INFORMATION:

REC.# 1561-1570 ARR TEST
 REC.# 1571 TEST TD
 REC.# 1606 PULSE TEST

CLIENT: U.S. NAVY PARTY NO.: 1184 PROSPECT: NPA-4 COUNTY: STATE: ALASKA COUNTRY: LEFT STORAGE: 700 ARRIVED FIELD: 730 LEFT FIELD: 500 ARRIVED STORAGE: 600 DATE: APR 8/75 OBSERVER: Vic Donald PAGE: 2 of 2

IDENTIFICATION				SHOT				SPREAD				TAPE				GAIN					FILTERS			REMARKS												
LINE	PROFILE	REEL NUMBER	FILE NUMBER	SHOT CAL	PLAY BACK	TIME	SIZE	TOP BOT	NO CAPS	CODE	S.P. OFFSET	NO. 1 DIR.	CODE	S.W. OFFSET	S.W. DEPTH	CDP SWITCH	SETUP	SAMPLE RATE MS	RECORD LENGTH	PARITY ERRORS	MODE	INITIAL GAIN (DB)					FINAL GAIN DB	RELEASE RATE	TRIP DELAY	HIGH CUT FREQ.	LOW CUT		NOTCH			
																						1-4	24		5-8	9-12					13-16	17-20	21-24	FREQ.	SLOPE	IN
37	125	523228	1626	A	AAW		55	83/90	2	0		N	0	10	14	1/17	0	✓	65sec		OP	54	54	54	40	36	120	EAST	Auto 576	124	8	36	OUT			
	126		1627				55	82/90	2						16	1/21							36	48	54	54										
	127		1630				55	82/90	2						16	1/25																				

SEISMOMETER AND SPREAD INFORMATION

CODE	SEIS. TYPE	NO./GP.	INT.	GROUP PATTERN	GP. INT.	SPREAD PATTERN

SHOT CONFIGURATION

SAME AS PAGE 1 OF 2

DFS III SYSTEM PARAMETERS:

GAIN CONSTANT _____ DB
 UPPER SET LIMIT _____ %
 LOWER SET LIMIT _____ %
 FORMAT TYPE:
 9 TRACK 21 TRACK
 GALVO LEVEL:
 1-24 _____ DB AUX _____ DB
 OTHER:

MISCELLANEOUS INFORMATION:

CLIENT		PARTY NO.	PROSPECT	COUNTY	STATE	COUNTRY	LEFT STORAGE	ARRIVED FIELD	LEFT FIELD	ARRIVED STORAGE	DATE	OBSERVER	PAGE																						
U.S. NAVY		1184	NPA-4	NOATH SLOPE	ALASKA	USA	700	730	600	100	APR 9/75	Tim Donald	109																						
IDENTIFICATION				SHOT				SPREAD				TAPE				GAIN				FILTERS			REMARKS												
LINE	PROFILE	REEL NUMBER	FILE NUMBER	SHOT CAL.	PLAY BACK	TIME	SIZE	TOP BOT.	NO CAPS	REEL CODE	S.P. OFFSET	NO. 1 DIR.	CODE	NO. OF SHOTS	SPREAD	CDP SWITCH	SETUP	SAMPLE RATE MS	RECORD LENGTH	PARITY ERRORS	MODE	INITIAL GAIN (DB)					FINAL GAIN DB	RELEASE RATE	TRIP DELAY	HIGH CUT FREQ.	LOW CUT		NOTCH		
37	128	523225	1642	A	APAW		55	82/90	2	①		N	①	10'	14	1/29	①	✓	6SEC		OP	54	54	54	48	48	36	120	FAST	576	124	8	36	OUT	ONLY PART OF CHARGE WENT
	129		1643				55	82/90	2						13	1/33							76	48	48	54	54	54		-WEAK					
	130		1644				55	82/90	2						15	1/37																			
	131		1645				55	82/90	2						16	1/41																			
	132		1646				55	82/90	1						15	1/45																			
	133		1650				55	75/83	2						13	1/1	①																		
	134		1651				50	72/90	2						14	1/5																			
	135		1652				50	72/90	2						13	1/9																			
	136		1653				50	72/90	2						17	1/13																			
	137		1654				50	72/90	2						17	1/17																			
	138		1655				50	72/90	2						13	1/21																			
	139		1656				50	72/90	2						13	1/25																			
	140		1657				50	72/90	2						13	1/29																			
	141		1660				50	72/90	2		400'W			260'	39	1/33																			
	142		1661				50	72/90	2						13	1/37																			
	143		1662				50	72/90	2						13	1/41																			
							TAPE CHANGE																												
	144	523226	1663				50	72/90	2						13	1/45																			
	145		1664				50	72/90	2						14	1/49																			
	146		1665				50	72/90	2						14	1/5	③																		
	147		1666				50	72/90	2						14	1/9																			
	148		1667				50	72/90	2						13	1/13																			

SEISMOMETER AND SPREAD INFORMATION

CODE	SEIS. TYPE	NO./GP.	INT.	SPREAD GROUP PATTERN	GP. INT.	GAP SPREAD PATTERN
①		9	12'	48 GROUPS INLINE 24/24 SPLIT NO GAP	330'	INLINE

SHOT CONFIGURATION

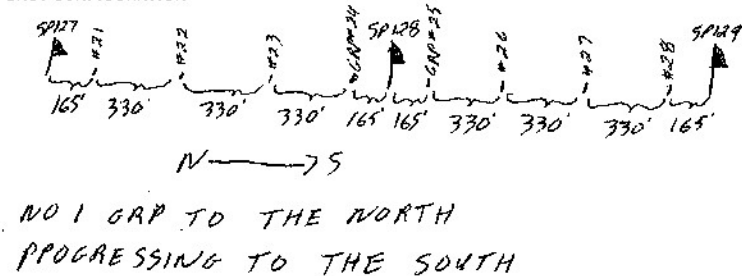

DFS III SYSTEM PARAMETERS:

GAIN CONSTANT 30 DB
 UPPER SET LIMIT 62.5 %
 LOWER SET LIMIT 18 %
 FORMAT TYPE:
 9 TRACK 21 TRACK
 GALVO LEVEL:
 1-24 21 DB AUX 15 DB
 OTHER:

MISCELLANEOUS INFORMATION:

REC # 1631 → 1640 RAD. TEST
 REC # 1641 TEST ID.
 REC # 1647 - PULSE TEST

CLIENT		PARTY NO.		PROSPECT		COUNTY		STATE		COUNTRY		LEFT STORAGE		ARRIVED FIELD		LEFT FIELD		ARRIVED STORAGE		DATE		OBSERVER		PAGE													
U.S. NAVY		1184		NPR-4		NORTH SLOPE		ALASKA		USA		780		730		700		800		APR 10/75		Vic Donald		1 of 2													
LINE	PROFILE	IDENTIFICATION		SHOT CAL.	PLAY BACK	TIME	SHOT				SPREAD				TAPE				GAIN						FILTERS			REMARKS									
		REEL NUMBER	FILE NUMBER				SIZE	TOP	NO CAPS	CODE	S.P. OFFSET	NO. 1 DIR.	CODE	S.D. SPLIT	NO. 2 DIR.	CODE	CDP SWITCH	SETUP	SAMPLE RATE MS	RECORD LENGTH	PARITY ERRORS	MODE	INITIAL GAIN (DB)						FINAL GAIN DB	RELEASE RATE	TRIP DELAY	HIGH CUT FREQ.	LOW CUT	NOTCH			
37	149	523226	1701	A	RAW		50	70/90	2	0		N	0	10'	47	17	0	✓	LSAC	OP	54	54	54	48	48	36	120	FIRST	AUTO 416	124	8	36	OUT				
	150		1702				50	73/90	2						13	1/21																					
	151		1703				50	73/90	2					200'	30	1/25																					
	152		1704				50	73/90	2					10'	14	1/29																					
	153		1705				50	73/90	2						13	1/33																					
	154		1706				55	83/90	2						12	1/37																					
	155		1707				55	83/90	2						14	1/41																					
	156		1710				55	83/90	2						17	1/45																					
	157		1711				55	83/90	2						14	1/49																					
	158		1713				55	83/90	2						18	1/5	0																				
	159		1714				55	83/90	2						14	1/9																					
	160		1715				55	83/90	2						14	1/13																					
	161		1716				50	73/90	2						15	1/17																					
	162		1717				50	73/90	2						13	1/21																					
	163		1720				50	73/90	2						14	1/25																					
	164		1721				50	73/90	2						15	1/29																					
	165		1722				50	73/90	2						14	1/33																					
	166		1723				50	73/90	2						13	1/37																					
	167	LAKE	1724				55	83/90	2					120'	17	1/41																					
	168		1725				50	73/90	2					10'	17	1/45																					
	169		1726				50	73/90	2						16	1/49																					
	170		1727				55	83/90	2						17	1/5	0																				
	171		1730				55	83/90	2						17	1/9																					
	172		1731				50	73/90	2						14	1/13																					
	173		1732				55	83/90	2						17	1/17																					
	174		1733				50	73/90	2						14	1/21																					
	175		1734				55	83/90	2					20'	18	1/25																					
	176		1735				50	73/90	2						14	1/29																					

SEISMOMETER AND SPREAD INFORMATION					
CODE	SEIS. TYPE	NO./GP.	INT.	GROUP PATTERN	SPREAD PATTERN
0		9	12'	INCLINE	48 GROUPS INCLINE 2 1/2 24 SPLIT NO GAP

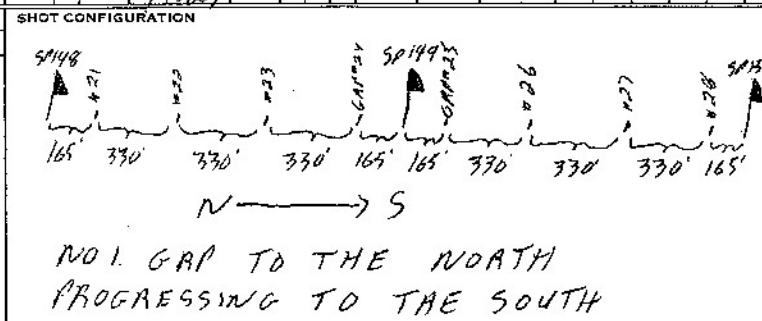

DFS III SYSTEM PARAMETERS:

GAIN CONSTANT 30 DB
 UPPER SET LIMIT 62.5 %
 LOWER SET LIMIT 16 %

FORMAT TYPE:
 9 TRACK 21 TRACK

GALVO LEVEL:
 1-24 21 DB AUX 15 DB

OTHER:

MISCELLANEOUS INFORMATION:

REC# 1670-1677 DAD TEST
 REC# 1700 TEST TB
 REC# 1712- PULSE TEST

CLIENT U.S. NAVY	PARTY NO. 1184	PROSPECT NPR-4	COUNTY NOATH SLOPE	STATE ALASKA	COUNTRY USA	LEFT STORAGE 700	ARRIVED FIELD 730	LEFT FIELD 700	ARRIVED STORAGE 900	DATE MAR 19 75	OBSERVER <i>Vic Donald</i>	PAGE 2 of 2
----------------------------	--------------------------	--------------------------	------------------------------	------------------------	-----------------------	----------------------------	-----------------------------	--------------------------	-------------------------------	--------------------------	-------------------------------	-----------------------

LINE	PROFILE	IDENTIFICATION		SHOT CAL.	PLAY BACK	TIME	SIZE	SHOT				SPREAD				TAPE				GAIN								FILTERS			REMARKS						
		REEL NUMBER	FILE NUMBER					NO CAPS	CODE	S.P. OFFSET	NO. 1 DIR.	CODE	S. D. SEIS. OFFSET	SEIS. DEPTH	CDP SWITCH	SETUP	SAMPLE RATE MS	RECORD LENGTH	PARITY ERRORS	MODE	INITIAL GAIN (DB)								FINAL GAIN DB	RELEASE RATE		TRIP DELAY	HIGH CUT FREQ.	LOW CUT		NOTCH	
																	1	2	4		1-4/24	5-8	9-12	13-16	17-20	21-24				FREQ.		SLOPE	IN	OUT			
37	177	523227	1736	A	ANW		50	73/90	2	0	70W	N	0	10'	47	12	1/33	ⓐ	✓	6500	CP	54	54	54	40	48	36	120	FAST	AWTD 512	124	8	36	OUT			
	178		1737				50	73/90	2						14	1/37						36	48	48	54	54											
	179		1740				55	82/90	2						14	1/41																					
	180		1741				50	73/90	2						17	1/45																					
	181		1742				55	87/90	2						17	1/49																					ECAMP CAUSING NOISE

SEISMOMETER AND SPREAD INFORMATION

CODE	SEIS. TYPE	NO./GP.	INT.	GROUP PATTERN	GP. INT.	SPREAD PATTERN
						SAME AS PAGE 1 OF 2

SHOT CONFIGURATION

--

DFS III SYSTEM PARAMETERS:

GAIN CONSTANT _____ DB
 UPPER SET LIMIT _____ %
 LOWER SET LIMIT _____ %
 FORMAT TYPE:
 9 TRACK 21 TRACK
 GALVO LEVEL:
 1-24 _____ DB AUX _____ DB
 OTHER:

MISCELLANEOUS INFORMATION:

CLIENT: U.S. NAVY PARTY NO: 1184 PROSPECT: NPR-4 COUNTY: STATE: ALASKA COUNTRY: U.S.A. LEFT STORAGE: 700 ARRIVED FIELD: 7:30 LEFT FIELD: 800 ARRIVED STORAGE: 900 DATE: APRIL 1978 OBSERVER: V. J. POHLE PAGE: 2 OF 2

LINE	PROFILE	IDENTIFICATION		SHOT CAL.	PLAY BACK	TIME	SHOT		NO. CAPS	CODE	S.P. OFFSET	SPREAD				TAPE			GAIN						FILTERS		REMARKS									
		REEL NUMBER	FILE NUMBER				SIZE	TOP				NO. 1 DIR.	CODE	S. D. SEIS. OFFSET	SEIS. DEPTH	COP SWITCH	SETUP	SAMPLE RATE MS	RECORD LENGTH	PARITY ERRORS	MODE	INITIAL GAIN (DB)						FINAL GAIN DB	RELEASE RATE	TRIP DELAY	HIGH CUT FREQ.	LOW CUT		NOTCH		
								BOT.										1	2	4		1-4/24	5-8	9-12	13-16	17-20		21-24			FREQ.	SLOPE	IN	OUT		
37	209	52322	2010	A	RAW		105	67/90	2	0		N	0	10'	12	1/27	0	✓	600	OP	54	54	59	48	36	36	130	FAST	1470	512	124	8	36	OUT		
	210		2011				100	67/90	2												36	48	48	54	54											
	211		2012				100	67/90	2																											
	212		2013				105	76/90	2																											
	213		2014				100	67/90	2																											
	214		2015				100	67/90	2																											
	215		2016				105	76/90	2																											
	216		2017				100	67/90	2																											
	217		2020				100	67/90	2																											TR#721 36 DEAD

SEISMOMETER AND SPREAD INFORMATION						
CODE	SEIS. TYPE	NO./GP.	INT.	GROUP PATTERN	GP. INT.	SPREAD PATTERN

SHOT CONFIGURATION
 SAME AS PAGE 1 OF 2

DFS III SYSTEM PARAMETERS:
 GAIN CONSTANT _____ DB
 UPPER SET LIMIT _____ %
 LOWER SET LIMIT _____ %
 FORMAT TYPE:
 9 TRACK 21 TRACK
 GALVO LEVEL:
 1-24 _____ DB AUX _____ DB
 OTHER:

MISCELLANEOUS INFORMATION:

CLIENT		PARTY NO.		PROSPECT		COUNTY		STATE		COUNTRY		LEFT STORAGE		ARRIVED FIELD		LEFT FIELD		ARRIVED STORAGE		DATE		OBSERVER		PAGE												
U.S. NAVY		1184		NPR-4		NORTH SLOPE		ALASKA		USA		700		730		6:00		7:00		APR 17/75		Vic Donald/T POHL		105												
LINE	PROFILE	IDENTIFICATION		SHOT CAL	PLAY BACK	TIME	SIZE	SHOT		NO CAPS	CODE	S.P. OFFSET	NO. DIR.	SPREAD		CDP SWITCH	SETUP	TAPE				GAIN						FILTERS		REMARKS						
		REEL NUMBER	FILE NUMBER					TOP	BOT					SEIS. DEPTH	SEIS. DEPTH			SAMPLE RATE MS	RECORD LENGTH	PARITY ERRORS	MODE	INITIAL GAIN (DB)						RELEASE RATE	TRIP DELAY		HIGH CUT FREQ.	LOW CUT	NOTCH			
37	218	57207	2032	A	MAN		105	76/90	2	0		N	0	10'	12	1/5	0	✓	656C	OP	54	54	54	48	48	36	120	FAST	AUTO 512	124	8	36	OUT			
	219		2033				100	64/90	2						11	1/9					76	48	48	48	48	48										
	220		2034				100	67/90							11	1/3																		Weak shot Allot charged		
	221		2035				100	67/90							12	1/7																				
	222		2036				700	67/90							11	1/61																				
	223		2037				105	76/90							11	1/25																				
	224		2040				100	67/90							11	1/29																				
	225		2041				100	47/90						1653	15	1/3																				
	226		2042				100	67/90							10	1/4																				
	227		2043				100	67/90							13	1/41																				
	228		2044				100	87/105							18	1/45																			MISSILE ON REC 2044	
	229		2046				100	87/105								1/49																				
	230	57228	2047				100	82/105							16	1/5	0																			
	231		2048				100	82/105							15	1/9																				
	232		2051				100	82/105							17	1/13																				
	233		2052				100	82/105							15	1/17																				
	234		2053				100	82/105							16	1/21																				No Log
	235		2054				100	82/105							15	1/25																				
	236		2055				100	82/105							15	1/29																				
	237		2056				100	82/105							15	1/33																				
	238		2057				100	82/105							15	1/37																				
	239		2060				100	82/105							16	1/41																				
	240		2061				100	82/105							17	1/45																				
	241		2062				100	82/105							16	1/49																				
	242		2064				100	82/105							16	1/5	0																			
	243		2065				100	82/105							20	1/9																				
	244		2066				100	82/105							16	1/13																				

SEISMOMETER AND SPREAD INFORMATION					
CODE	SEIS. TYPE	NO./GP.	INT.	GROUP PATTERN	GP. INT.
0		9	12'	INLINE	330'
SPREAD PATTERN					
48 GROUPS INLINE 24/24 SPLIT NO GAP					

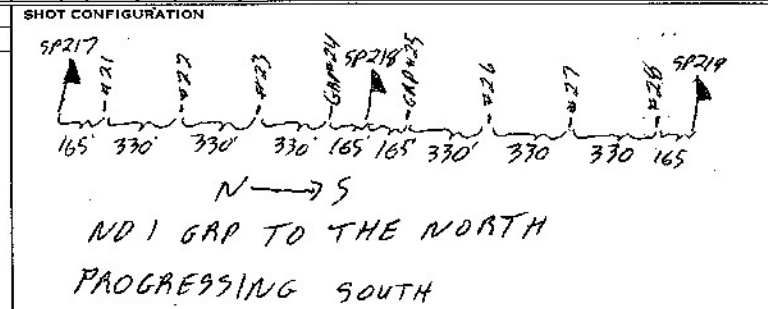

DFS III SYSTEM PARAMETERS:

GAIN CONSTANT 30 DB

UPPER SET LIMIT 62.5 %

LOWER SET LIMIT 16 %

FORMAT TYPE:

9 TRACK 21 TRACK

GALVO LEVEL:

1-24 21 DB AUX 15 DB

OTHER:

MISCELLANEOUS INFORMATION:

REC # 2021 → 2030 RRD TEST

REC # 2031 TEST JOB

LEV # 2063 Plus Test

CLIENT		PARTY NO.	PROSPECT	COUNTY	STATE	COUNTRY	LEFT STORAGE	ARRIVED FIELD	LEFT FIELD	ARRIVED STORAGE	DATE	OBSERVER	PAGE																								
U. S. NAVY		1184	NPX-4	North Slope	Alaska	U. S. A.	7:00	7:30			APR 12/75	J. P. ... / Vic. ...	2 of 2																								
LINE	PROFILE	IDENTIFICATION			PLAY BACK	TIME	SIZE	SHOT		NO CAPS	CODE	S.P. OFFSET	NO. 1 DIR.	CODE	SPREAD				CDP SWITCH	SETUP	TAPE			MODE	GAIN						RELEASE RATE	TRIP DELAY	HIGH CUT FREQ.	FILTERS		NOTCH	REMARKS
		REEL NUMBER	FILE NUMBER	SHOT CAL.				TOP	BOT.						1	2	4	RECORD LENGTH			PARITY ERRORS	1-4/24	5-6		9-12	13-16	17-20	21-24	FINAL GAIN DB	FREQ.				SLOPE	IN		

SEISMOMETER AND SPREAD INFORMATION

CODE	SEIS. TYPE	NO./GP.	INT.	GROUP PATTERN	GP. INT.	SPREAD PATTERN

SHOT CONFIGURATION

Same as sheet 1

DFS III SYSTEM PARAMETERS:

GAIN CONSTANT _____ DB
 UPPER SET LIMIT _____ %
 LOWER SET LIMIT _____ %
 FORMAT TYPE:
 9 TRACK 21 TRACK
 GALVO LEVEL:
 1-24 _____ DB AUX _____ DB
 OTHER:

MISCELLANEOUS INFORMATION:

CLIENT		PARTY NO.	PROSPECT	COUNTY	STATE	COUNTRY	LEFT STORAGE	ARRIVED FIELD	LEFT FIELD	ARRIVED STORAGE	DATE	OBSERVER	PAGE																						
U. S. NAVY		1184	NPR-4	North Slope	Alaska	U. S. A.	7:00	8:00	6:30	8:30	4-14-75	L. R. Bell	1 of 1																						
IDENTIFICATION				SHOT				SPREAD				TAPE				GAIN				FILTERS		REMARKS													
LINE	PROFILE	REEL NUMBER	FILE NUMBER	SHOT CAL.	PLAY BACK	TIME	SIZE	TOP BOT.	NO CAPS	CODE	S.P. OFFSET	NO. 1 DIR.	CODE	S.P. OFFSET	SEIS. DEPTH	CDP SWITCH	SETUP	SAMPLE RATE MS	RECORD LENGTH	PARITY ERRORS	MODE		INITIAL GAIN (DB)				FINAL GAIN DB	RELEASE RATE	TRIP DELAY	HIGH CUT FREQ.	LOW CUT		NOTCH		
37	251	52328	2104	A-1			100	87/105	2	①		N	10	144	15	1/41	①	7	6		ALC	54	57	54	48	48	36	120	F057	512	124	8	36	OUT	
37	252		2107	2			100	87/105	2						15	1/42							36	48	48	37	54	54							
	253		2110	3			100	87/105	2						16	1/49																			
	254		2112	4			100	87/105	2	②					15	1/45	②																		
	255		2113	5			100	87/105	2						13	1/49																			
	256		2114	6			100	87/105	2						15	1/43																			
	257		2115	7			100	87/105	2						14	1/49																			
	258		2116	8			100	87/105	2						14	1/21																			
	259		2117	9			100	87/105	2						15	1/45																			
	260		2120	10			100	87/105	2						15	1/49																			
	261		2121	11			100	87/105	2						14	1/33																			
	262		2122	12			100	87/105	2						15	1/37																			
	263		2123	13			100	87/105	2						15	1/41																			
	264		2124	14			100	87/105	2						15	1/45																			
	265		2125	15			100	87/105	2						15	1/49																			
	266		2126	16			100	87/105	2						15	1/45	③																		
	247		2127	17			100	87/105	2						16	1/49																			

wind ~~blowing~~ started to blow on sp. 254-256

End of Line 37

SEISMOMETER AND SPREAD INFORMATION					SHOT CONFIGURATION		DFS III SYSTEM PARAMETERS:		MISCELLANEOUS INFORMATION:	
CODE	SEIS. TYPE	NO./GP.	INT.	GROUP PATTERN	GP. INT.	SPREAD PATTERN				
0		9	12'	Enine	330'	48 G-RAs Enine 24R4 SMT No G-R				
							GAIN CONSTANT 30 DB		21075-2104 DRD	
							UPPER SET LIMIT 62.5 %		RST TB - 2005	
							LOWER SET LIMIT 18 %		BV-2111 Phase Test	
							FORMAT TYPE:			
							<input type="checkbox"/> 9 TRACK <input checked="" type="checkbox"/> 21 TRACK			
							GALVO LEVEL:			
							1-24 21 DB AUX 15 DB			
							OTHER:			
							N → S			
							NO 1 G-R TO NORTH			
							PROGRESSING SOUTH			