

STADIA SURVEY NOTES

AREA Barrow STATE or PROVINCE Alaska PAGE No. 16
 LINE No.(s) M PARTY No. 195 DATE 9 Day 12 Mo. 72 Yr. BOOK No. 2
 SURVEYOR Byrd RODMAN myers WEATHER: Foggy - mild P.T.S. No.

LINE	Bearing of Sight	Stadia Distance	BEAMAN OR VERNIER			ROD READING			Center Hair	Angular Elev. Diff.	Final Elev. Diff.	ELEVATIONS		A.B.S. OF S.S.	Station	REMARKS
			Level	Inclined	Angle or Factor	Hair Read	Reading	Correc-tion				INST.	ROD			
1			ELEVATIONS STARTED SP22 (R-7)						REF. Pt II BK 2							
2		225										1.5			Tail spread	
3		825	✓					+10.1			11.6			△		
4		440	✓					12.7		-12.7		-1.1		△	SP1 - SEA level	
5		00	✓					-5.2		-5.2		6.4			SP2 ST BANK	
6		440	✓					5.1		-5.1		6.5		⊙	SP3	
7		440	✓					6.3		+6.3	12.8			△		
8		00	✓					5.2		-5.2		7.6			SP4	
9		440	✓					5.8		-5.8		7.0			SP5	
10		880	✓					6.0		-6.0		6.8		⊙	SP6	
11		440	✓					6.1		+6.1	12.9			△	SP7	
12		00	✓					5.2		-5.2		7.7			SP7	
13		440	✓					5.2		-5.2		7.7		⊙	SP8	
14		880	✓					3.6		+3.6	11.3			△		
15		440	✓					4.2		-4.2		7.1			9	
16		00	✓					5.2		-5.2		6.1			10	
17		440	✓					8.0		-8.0		3.3			18	
18		880	✓					11.1		-11.1		0.2		⊙	12	
19		880	✓					13.2		+13.2	13.4			△		
20		440	✓					7.4		-7.4		6.0			SP 13	

WORKED BY Byrd CHECKED BY 1st RPB 2nd P

STADIA SURVEY NOTES

AREA Birrow STATE or PROVINCE Alaska PAGE No. 17
 LINE No.(s) M PARTY No. 195 DATE 9 Day 12 Mo. 22 Yr. BOOK No. 2
 SURVEYOR Byrd RODMAN Myers WEATHER: Pair P.T.S. No.

LINE	Bearing of Sight	Stadia Distance	BEAMAN OR VERNIER			ROD READING				Angular Elev. Diff.	Final Elev. Diff.	ELEVATIONS		A.S.S. OF S. - S.S.	Station	REMARKS
			Level	Inclined	Angle or Factor	Hair Read	Reading	Correc-tion	Center Hair			INST.	ROD			
1												13.4				
2		00	✓									-5.2	-5.2		sp 14	STARTING
3		440	✓									-5.6	-5.6		15	ELEVATION
4		880	✓									-5.2	-5.2	⊙	⊙ 16	TAKEN FROM
5	1320	880	✓									+5.9	+5.9	Δ	⊙ 17	RA L 13.11
6	880	440	✓									-6.2	-6.2		sp 17	EX 2
7	440	00	✓									-6.2	-6.2		18	
8		00	✓									-5.2	-5.2		19	
9		440	✓									-8.4	-8.4		20	
10		880	✓									-13.6	-13.6		21	
11	1320	✓										-10.8	-10.8	⊙	22	(R-7, in h cross
12	880	✓									11.5	+8.2	+8.2	Δ		
13	440	✓										-10.8	-10.2		23	
14	00	✓										-5.2	-5.2		sp 24	
15	440	✓										-5.0	-5.0		25	
16	880	✓										-5.4	-5.4	⊙	26	
17	880	✓									9.1	+3.0	+3.0	Δ		
18	440	✓										-4.2	-4.2		27	
19	00	✓										-5.2	-5.2		28	
20	440	✓										-4.4	-4.4		29	

WORKED BY Jim

CHECKED BY 1st BB

2nd P

STADIA SURVEY NOTES

AREA Barrow STATE or PROVINCE Alaska PAGE No. 18
 LINE No.(s) M PARTY No. 195 DATE 10 Day 12 Mo. 12 Yr. BOOK No. 2
 SURVEYOR Byrd RODMAN Myers WEATHER: Cold -5° P.T.S. No. _____

LINE	Bearing of Sight	Stadia Distance	BEAMAN OR VERNIER			ROD READING				Angular Elev. Diff.	Final Elev. Diff.	ELEVATIONS		AB.S. OF S. -S.S.	Station	REMARKS
			Level	Inclined	Angle or Factor	Hair Read	Reading	Correc-tion	Center Hair			INST.	ROD			
1											9.1					
2		880 ✓									-3.7	5.4	⊙	SP	30	
3		880 ✓									+6.1	11.5	Δ			
4		440 ✓									-5.8	5.7			31	
5		00 ✓									-5.2	6.3		SP	32	
6		440 ✓									-4.8	6.7			33	
7		880 ✓									-5.2	6.3	⊙		34	
8	440	880 ✓									+6.4	12.7	Δ			
9	00	440 ✓									-5.2	7.5			35	
10	440	00 ✓									-5.2	7.5			36	
11	880	440 ✓									-5.2	7.5	⊙		37	
12		880 ✓									+8.6	16.1	Δ			
13		440 ✓									-8.0	8.1			38	
14		00 ✓									-5.2	10.9			39	
15		440 ✓									-7.4	8.7			40	
16		880 ✓									-6.9	9.2	⊙		41	
17		880 ✓									+7.5	16.7	Δ			
18		440 ✓									-6.8	9.9			42	
19		00 ✓									+5.2	11.5			43	
20		440 ✓									-5.6	11.1			44	

WORKED BY SM CHECKED BY 1st RB 2nd _____

STADIA SURVEY NOTES

AREA Barrow STATE or PROVINCE Alaska PAGE No. 19
 LINE No.(s) M PARTY No. 195 DATE 10 Day 12 Mo. 22 Yr. BOOK No. 21
 SURVEYOR Byrd RODMAN Myers WEATHER: yes P.T.S. No.

LINE	Bearing of Sight	Stadia Distance	BEAMAN OR VERNIER			ROD READING				Angular Elev. Diff.	Final Elev. Diff.	ELEVATIONS		A.B.S. OF S. - S.S.	Station	REMARKS
			Level	Inclined	Angle or Factor	Hair Read	Reading	Correction	Center Hair			INST.	ROD			
1												16.7				
2		880	✓									-5.3	11.4	⊙	sp 45	
3		880	✓									+8.0	19.4	△		
4		440	✓									-7.8	11.6		46	
5		00										-5.2	14.2		47	
6		440	✓									-4.8	14.6		48	
7		880	✓									-4.6	14.8	⊙	49	
8		880	✓									+9.5	24.3	△		
9	440	440	✓									-8.0	16.3		50	
10		00	✓									-5.2	19.1		51	
11		440	✓									-2.4	21.9		52	
12		880	✓									-2.0	22.3	⊙	53	
13		880	✓									+6.7	29.0	△		
14		440	✓									-5.2	23.8		54	
15		00	✓									-5.2	23.8		55	
16		440	✓									-5.0	24.0		56	
17		880	✓									-5.2	23.8	⊙	57	
18		880	✓									+6.4	30.2	△		
19		440	✓									-6.2	24.0		58	
20		00	✓									-5.2	25.0		59	

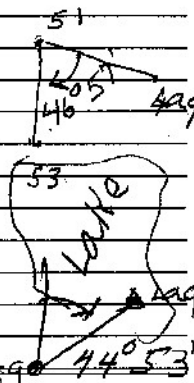

WORKED BY SLM CHECKED BY 1st BB 2nd W

STADIA SURVEY NOTES

AREA Barrow STATE or PROVINCE Alaska PAGE No. 20
 LINE No.(s) M PARTY No. 195 DATE 10 Day 12 Mo. 72 Yr. BOOK No. 2
 SURVEYOR Byrd RODMAN Myers WEATHER: Fair P.T.S. No. _____

LINE	Bearing of Sight	Stadia Distance	BEAMAN OR VERNIER			ROD READING				Angular Elev. Diff.	Final Elev. Diff.	ELEVATIONS		▲B.S. O.F.S. -S.S.	Station	REMARKS
			Level	Inclined	Angle or Factor	Hair Read	Reading	Correc-tion	Center Hair			INST.	ROD			
1												30.2				
2		440	✓						-6.4	-6.4		23.8		60		
3		880	✓						-7.8	-7.8		22.4	⊙	61		
4		880	✓						+4.7	+4.7	27.1		Δ			
5		440	✓						-5.4	-5.4		21.7		62		
6		00	✓						-5.2	-5.2		21.9		63		
7		440	✓						-4.4	-4.4		22.7		64		
8		880	✓						-2.7	-2.7		24.4	⊙	65		
9		440	✓						+5.0	+5.0	29.4		Δ			
10		00	✓						-5.2	-5.2		24.2		66		
11		440	91°	40'00"	-2.91				10.0	-12.8	-22.8	6.6		67		
12		1265	90°	45'00"	-1.31				10.0	-16.6	-26.6	2.8			FAI spread	
13																
14																
15																
16																
17																
18																
19																
20																

WORKED BY Jim CHECKED BY 1st Bob 2nd A